

* required information

Section 1 of 18

You can save the form at any time and resume it later. You do not need to be logged in when you resume.

System reference

Not Currently In Use

This is the unique reference for this application generated by the system.

Your reference

CVE/88/187/RPB

You can put what you want here to help you track applications if you make lots of them. It is passed to the authority.

Are you an agent acting on behalf of the applicant?

☒ Yes ☐ No

Put "no" if you are applying on your own behalf or on behalf of a business you own or work for.

Applicant Details

* First name

BP Oil UK Limited

* Family name

BP Oil UK Limited

* E-mail

cedwards@wslaw.co.uk

Main telephone number

020 7593 0366

Include country code.

Other telephone number

☐ Indicate here if the applicant would prefer not to be contacted by telephone

Is the applicant:

- ☒ Applying as a business or organisation, including as a sole trader
☐ Applying as an individual

A sole trader is a business owned by one person without any special legal structure. Applying as an individual means **the** applicant is applying so the applicant can be employed, or for some other personal reason, such as following a hobby.

Applicant Business

Is the applicant's business registered in the UK with Companies House?

☒ Yes ☐ No

Note: completing the Applicant Business section is optional in this form.

Registration number

00446915

Business name

BP Oil UK Limited

If the applicant's business is registered, use its registered name.

VAT number

-

N/A

Put "none" if the applicant is not registered for VAT.

Legal status

Private Limited Company

Continued from previous page...

Applicant's position in the business

Legal Team

Home country

United Kingdom

The country where the applicant's headquarters are.

Registered Address

Address registered with Companies House.

Building number or name

Registered Address

Street

Chertsey Road

District

City or town

Sunbury on Thames

County or administrative area

Postcode

TW16 7BP

Country

United Kingdom

Agent Details

* First name

Charlotte Edwards

* Family name

Winckworth Sherwood LLP

* E-mail

cedwards@wslaw.co.uk

Main telephone number

020 7593 0366

Include country code.

Other telephone number

☐ Indicate here if you would prefer not to be contacted by telephone

Are you:

☒ An agent that is a business or organisation, including a sole trader

☐ A private individual acting as an agent

A sole trader is a business owned by one person without any special legal structure.

Agent Business

Is your business registered in the UK with Companies House?

☒ Yes

☐ No

Note: completing the Applicant Business section is optional in this form.

Registration number

Oc334359

Business name

Winckworth Sherwood LLP

If your business is registered, use its registered name.

VAT number

-

N/A

Put "none" if you are not registered for VAT.

Legal status

Partnership

Continued from previous page...

Your position in the business	<input type="text" value="Licensing Assistant"/>	
Home country	<input type="text" value="United Kingdom"/>	The country where the headquarters of your business is located.
Agent Registered Address		Address registered with Companies House.
Building number or name	<input type="text" value="Minerva House"/>	
Street	<input type="text" value="5 Montague Close"/>	
District	<input type="text"/>	
City or town	<input type="text" value="London"/>	
County or administrative area	<input type="text"/>	
Postcode	<input type="text" value="SE1 9BB"/>	
Country	<input type="text" value="United Kingdom"/>	

Section 2 of 18

APPLICATION DETAILS

This application cannot be used to vary the licence so as to extend the period for which the licence has effect or to vary substantially the premises to which it relates. If you wish to make that type of change to the premises licence, you should make a new premises licence application under section 17 of the Licensing Act 2003.

I/we, as named in section 1, being the premises licence holder, apply to vary a premises licence under section 34 of the Licensing Act 2003 for the premises described in section 2 below.

* Premises Licence Number

Are you able to provide a postal address, OS map reference or description of the premises?

☒ Address ☐ OS map reference ☐ Description

Postal Address Of Premises

Building number or name	<input type="text" value="Chigwell SF Connect"/>
Street	<input type="text" value="The Broadway"/>
District	<input type="text"/>
City or town	<input type="text" value="Loughton"/>
County or administrative area	<input type="text"/>
Postcode	<input type="text" value="IG10 3ST"/>
Country	<input type="text" value="United Kingdom"/>

Premises Contact Details

Telephone number

Continued from previous page...

Non-domestic rateable
value of premises (£)

80,000

Section 3 of 18

VARIATION

Do you want the proposed
variation to have effect as
soon as possible?

☒ Yes

☐ No

Do you want the proposed variation to have effect in relation to the
introduction of the late night levy?

☐ Yes

☒ No

You do not have to pay a fee if the only
purpose of the variation for which you are
applying is to avoid becoming liable to the
late night levy.

If your proposed variation
would mean that 5,000 or
more people are expected to
attend the premises at any
one time, state the number
expected to attend

Describe Briefly The Nature Of The Proposed Variation

Describe the premises. For example the type of premises, its general situation and layout and any other information which could be relevant to the licensing objectives. Where your application includes off-supplies of alcohol and you intend to provide a place for consumption of these off-supplies, you must include a description of where the place will be and its proximity to the premises.

A petrol forecourt store selling a broad range of groceries, household products and alcohol. Situated on The Broadway, Loughton, IG10 3ST to be varied as follows:

1. To extend the hours for the sale of alcohol to 24 hours a day 7 days a week.
2. To remove the conditions set out in Annex 2 of the premises licence.
3. To include the conditions in boxes b to e of Section 16 of the application .

Section 4 of 18

PROVISION OF PLAYS

[See guidance on regulated entertainment](#)

Will the schedule to provide plays be subject to change if this application to
vary is successful?

☐ Yes

☒ No

Section 5 of 18

PROVISION OF FILMS

[See guidance on regulated entertainment](#)

Will the schedule to provide films be subject to change if this application to
vary is successful?

☐ Yes

☒ No

Section 6 of 18

Continued from previous page...

PROVISION OF INDOOR SPORTING EVENTS

[See guidance on regulated entertainment](#)

Will the schedule to provide indoor sporting events be subject to change if this application to vary is successful?

☐ Yes ☒ No

Section 7 of 18

PROVISION OF BOXING OR WRESTLING ENTERTAINMENTS

[See guidance on regulated entertainment](#)

Will the schedule to provide boxing or wrestling entertainments be subject to change if this application to vary is successful?

☐ Yes ☒ No

Section 8 of 18

PROVISION OF LIVE MUSIC

[See guidance on regulated entertainment](#)

Will the schedule to provide live music be subject to change if this application to vary is successful?

☐ Yes ☒ No

Section 9 of 18

PROVISION OF RECORDED MUSIC

[See guidance on regulated entertainment](#)

Will the schedule to provide recorded music be subject to change if this application to vary is successful?

☐ Yes ☒ No

Section 10 of 18

PROVISION OF PERFORMANCES OF DANCE

[See guidance on regulated entertainment](#)

Will the schedule to provide performances of dance be subject to change if this application to vary is successful?

☐ Yes ☒ No

Section 11 of 18

PROVISION OF ANYTHING OF A SIMILAR DESCRIPTION TO LIVE MUSIC, RECORDED MUSIC OR PERFORMANCES OF DANCE

[See guidance on regulated entertainment](#)

Will the schedule to provide anything similar to live music, recorded music or performances of dance be subject to change if this application to vary is successful?

☐ Yes ☒ No

Section 12 of 18

Continued from previous page...

PROVISION OF LATE NIGHT REFRESHMENT

Will the schedule to provide late night refreshment be subject to change if this application to vary is successful?

☐ Yes ☒ No

Section 13 of 18

SUPPLY OF ALCOHOL

Will the schedule to supply alcohol be subject to change if this application to vary is successful?

☒ Yes ☐ No

Standard Days And Timings

MONDAY

Start

End

Start

End

Provide timings in 24 hour clock (e.g., 16:00) and only give details for the days of the week when you intend the premises to be used for the activity.

TUESDAY

Start

End

Start

End

WEDNESDAY

Start

End

Start

End

THURSDAY

Start

End

Start

End

FRIDAY

Start

End

Start

End

SATURDAY

Start

End

Start

End

SUNDAY

Start

End

Start

End

Continued from previous page...

WEDNESDAY

Start

End

Start

End

THURSDAY

Start

End

Start

End

FRIDAY

Start

End

Start

End

SATURDAY

Start

End

Start

End

SUNDAY

Start

End

Start

End

State any seasonal variations.

For example (but not exclusively) where the activity will occur on additional days during the summer months.

Non standard timings. Where you intend to use the premises to be open to the members and guests at different times from those listed above, list below.

For example (but not exclusively), where you wish the activity to go on longer on a particular day e.g. Christmas Eve.

Identify those conditions currently imposed on the licence which you believe could be removed as a consequence of the proposed variation you are seeking.

1. The hours for the sale of alcohol are currently restricted to:

Monday to Sunday: 0800 to 2300

2. The conditions in Annex 2.

The above conditions and restrictions would be removed as a consequence of the proposed variation.

Continued from previous page...

Will the sale of alcohol be for consumption?

☐ On the premises ☒ Off the premises ☐ Both

If the sale of alcohol is for consumption on the premises select on, if the sale of alcohol is for consumption away from the premises select off. If the sale of alcohol is for consumption on the premises and away from the premises select both.

State any seasonal variations.

For example (but not exclusively) where the activity will occur on additional days during the summer months.

Non-standard timings. Where the premises will be used for the supply of alcohol at different times from those listed above, list below.

For example (but not exclusively), where you wish the activity to go on longer on a particular day e.g. Christmas Eve.

Section 14 of 18

ADULT ENTERTAINMENT

Highlight any adult entertainment or services, activities, or other entertainment or matters ancillary to the use of the premises that may give rise to concern in respect of children.

Provide information about anything intended to occur at the premises or ancillary to the use of the premises which may give rise to concern in respect of children, regardless of whether you intend children to have access to the premises, for example (but not exclusively) nudity or semi-nudity, films for restricted age groups etc gambling machines etc.

The premises sell alcohol and other age restricted products.

Section 15 of 18

HOURS PREMISES ARE OPEN TO THE PUBLIC

Standard Days And Timings

MONDAY

Start

End

Start

End

TUESDAY

Start

End

Start

End

Provide timings in 24 hour clock (e.g., 16:00) and only give details for the days of the week when you intend the premises to be used for the activity.

Continued from previous page...

- ☒ I have enclosed the premises licence
- ☐ I have enclosed the relevant part of the premises licence

Reasons why I have failed to enclose the premises licence or relevant part of premises licence.

Section 16 of 18

LICENSING OBJECTIVES

Describe the steps you intend to take to promote the four licensing objectives:

a) General – all four licensing objectives (b,c,d,e)

List here steps you will take to promote all four licensing objectives together.

b) The prevention of crime and disorder

1. A digital CCTV system will be installed, or the existing system maintained, such system to be fit for the purpose.
2. The CCTV system shall be capable of producing immediate copies on site. Copies of recordings will either be recorded digitally on to CD/DVD or other equivalent medium.
3. Any recording will be retained and stored in a suitable and secure manner for a minimum of 31 days and shall be made available, subject to compliance with Data Protection legislation, to the police for inspection on request.
4. The precise positions of the cameras may be agreed, subject to compliance with Data Protection legislation, with the police from time to time.
5. The system will display, on any recording, the correct time and date of the recording.
6. The CCTV system will be maintained and fully operational throughout the hours that the premises are open for any licensable activity.

c) Public safety

The premises licence holder will at all times maintain adequate levels of staff. Such staff levels will be disclosed, on request, to the licensing authority and police.

d) The prevention of public nuisance

Adequate waste receptacles for use by customers shall be provided in and immediately outside the premises.

e) The protection of children from harm

Continued from previous page...

The premises licence holder will ensure that an age verification policy will apply to the premises whereby all cashiers will be trained to ask any customer attempting to purchase alcohol, who appears to be under the age of 25 years (or older if the licence holder so elects) to produce, before being sold alcohol, identification being a passport or photocard driving licence bearing a holographic mark or other form of identification that complies with any mandatory condition that may apply to this licence.

Section 17 of 18

NOTES ON REGULATED ENTERTAINMENT

In terms of specific **regulated entertainments** please note that:

- **Plays:** no licence is required for performances between 08:00 and 23:00 on any day, provided that the audience does not exceed 500.
- **Films:** no licence is required for 'not-for-profit' film exhibition held in community premises between 08:00 and 23:00 on any day provided that the audience does not exceed 500 and the organiser (a) gets consent to the screening from a person who is responsible for the premises; and (b) ensures that each such screening abides by age classification ratings.
- **Indoor sporting events:** no licence is required for performances between 08:00 and 23:00 on any day, provided that the audience does not exceed 1000.
- **Boxing or Wrestling Entertainment:** no licence is required for a contest, exhibition or display of Greco-Roman wrestling, or freestyle wrestling between 08:00 and 23:00 on any day, provided that the audience does not exceed 1000. Combined fighting sports – defined as a contest, exhibition or display which combines boxing or wrestling with one or more martial arts – are licensable as a boxing or wrestling entertainment rather than an indoor sporting event.
- **Live music:** no licence permission is required for:
 - o a performance of unamplified live music between 08:00 and 23:00 on any day, on any premises.
 - o a performance of amplified live music between 08:00 and 23:00 on any day on premises authorised to sell alcohol for consumption on those premises, provided that the audience does not exceed 500.
 - o a performance of amplified live music between 08:00 and 23:00 on any day, in a workplace that is not licensed to sell alcohol on those premises, provided that the audience does not exceed 500.
 - o a performance of amplified live music between 08:00 and 23:00 on any day, in a church hall, village hall, community hall, or other similar community premises, that is not licensed by a premises licence to sell alcohol, provided that (a) the audience does not exceed 500, and (b) the organiser gets consent for the performance from a person who is responsible for the premises.
 - o a performance of amplified live music between 08:00 and 23:00 on any day, at the non-residential premises of (i) a local authority, or (ii) a school, or (iii) a hospital, provided that (a) the audience does not exceed 500, and (b) the organiser gets consent for the performance on the relevant premises from: (i) the local authority concerned, or (ii) the school or (iii) the health care provider for the hospital.
- **Recorded Music:** no licence permission is required for:
 - o any playing of recorded music between 08:00 and 23:00 on any day on premises authorised to sell alcohol for consumption on those premises, provided that the audience does not exceed 500.
 - o any playing of recorded music between 08:00 and 23:00 on any day, in a church hall, village hall, community hall, or other similar community premises, that is not licensed by a premises licence to sell alcohol, provided that (a) the audience does not exceed 500, and (b) the organiser gets consent for the performance from a person who is responsible for the premises.
 - o any playing of recorded music between 08:00 and 23:00 on any day, at the non-residential premises of (i) a local authority, or (ii) a school, or (iii) a hospital, provided that (a) the audience does not exceed 500, and (b) the organiser gets consent for the performance on the relevant premises from: (i) the local authority concerned, or (ii) the school proprietor or (iii) the health care provider for the hospital.

Continued from previous page...

- Dance: no licence is required for performances between 08.00 and 23.00 on any day, provided that the audience does not exceed 500. However, a performance which amounts to adult entertainment remains licensable.
- Cross activity exemptions: no licence is required between 08.00 and 23.00 on any day, with no limit on audience size for:
 - o any entertainment taking place on the premises of the local authority where the entertainment is provided by or on behalf of the local authority;
 - o any entertainment taking place on the hospital premises of the health care provider where the entertainment is provided by or on behalf of the health care provider;
 - o any entertainment taking place on the premises of the school where the entertainment is provided by or on behalf of the school proprietor; and
 - o any entertainment (excluding films and a boxing or wrestling entertainment) taking place at a travelling circus, provided that (a) it takes place within a moveable structure that accommodates the audience, and (b) that the travelling circus has not been located on the same site for more than 28 consecutive days.

Section 18 of 18

PAYMENT DETAILS

This fee must be paid to the authority. If you complete the application online, you must pay it by debit or credit card.

Variation Fees are determined by the non-domestic rateable value of the premises.

To find out a premises non domestic rateable value go to the Valuation Office Agency site at http://www.voa.gov.uk/business_rates/index.htm

Band A - No RV to £4300 £100.00

Band B - £4301 to £33000 £190.00

Band C - £33001 to £8700 £315.00

Band D - £87001 to £12500 £450.00*

Band E - £125001 and over £635.00*

*If the premises rateable value is in Bands D or E and the premises is primarily used for the consumption of alcohol on the premises then you are required to pay a higher fee

Band D - £87001 to £12500 £900.00

Band E - £125001 and over £1,905.00

If you own a large premise you are subject to additional fees based upon the number in attendance at any one time

Capacity 5000-9999 £1,000.00

Capacity 10000 -14999 £2,000.00

Capacity 15000-19999 £4,000.00

Capacity 20000-29999 £8,000.00

Capacity 30000-39000 £16,000.00

Capacity 40000-49999 £24,000.00

Capacity 50000-59999 £32,000.00

Capacity 60000-69999 £40,000.00

Capacity 70000-79999 £48,000.00

Capacity 80000-89999 £56,000.00

Capacity 90000 and over £64,000.00

* Fee amount (£)

315.00

DECLARATION

* I/we understand it is an offence, liable on conviction to a fine up to level 5 on the standard scale, under section 158 of the licensing act 2003, to make a false statement in or in connection with this application.

☒ Ticking this box indicates you have read and understood the above declaration

This section should be completed by the applicant, unless you answered "Yes" to the question "Are you an agent acting on behalf of the applicant?"

Continued from previous page...

* Full name

* Capacity

* Date / /
dd mm yyyy

[Add another signatory](#)

Once you're finished you need to do the following:

1. Save this form to your computer by clicking file/save as...
2. Go back to <https://www.gov.uk/apply-for-a-licence/premises-licence/epping-forest/change-1> to upload this file and continue with your application.

Don't forget to make sure you have all your supporting documentation to hand.

IT IS AN OFFENCE, UNDER SECTION 158 OF THE LICENSING ACT 2003, TO MAKE A FALSE STATEMENT IN OR IN CONNECTION WITH THIS APPLICATION. THOSE WHO MAKE A FALSE STATEMENT MAY BE LIABLE ON SUMMARY CONVICTION TO A FINE OF ANY AMOUNT.

OFFICE USE ONLY

Applicant reference number

Fee paid

Payment provider reference

ELMS Payment Reference

Payment status

Payment authorisation code

Payment authorisation date

Date and time submitted

Approval deadline

Error message

Is Digitally signed ☐

[1](#) [2](#) [3](#) [4](#) [5](#) [6](#) [7](#) [8](#) [9](#) [10](#) [11](#) [12](#) [13](#) [14](#) [15](#) [16](#) [17](#) [18](#) [Next >](#)

PREMISES LICENCE

Part A



Neighbourhoods
Directorate

Premises licence number:

LN/210001541

Part 1 – Premises details:

Postal address of premises, or if none, ordnance survey map reference or description:

BP Express
Chigwell Service Station
The Broadway

Post Town: Loughton

Post code: IG10 3ST

Telephone number: N/A

Where the licence is time limited the dates: N/A

Licensable activities authorised by the licence:

Late Night Refreshment
Sale of Alcohol

The times the licence authorises the carrying out of licensable activities:

Late Night Refreshment
Monday – Sunday 23.00-05.00

Sale of Alcohol
Monday – Sunday 08.00-23.00

The opening hours of the premises:

Monday – Sunday 00:01 – 00:00

Where the licence authorises supplies of alcohol whether these are on and / or off supplies:

Off Only

Name, (registered) address, telephone number and e-mail (where relevant) of holder of premises licence:

BP Oil UK Ltd,
Chertsey Road, Sunbury on Thames, Middlesex, TW16 7BP
01908 853 000

Registered number of holder, for example company number, charity number (where applicable):
Company 00446915

Name, address and telephone number of designated premises supervisor where the premises licence authorises the supply of alcohol:

Thuralrajah Nirupan



Personal licence number and issuing authority of personal licence held by designated premises supervisor where the premises licence authorises for the supply of alcohol:

**Newham London Borough Council
06/00102/LAPER**

Mandatory Conditions
All Premises Licence authorising supply of alcohol

The licence is granted subject to the Mandatory conditions for sale of alcohol as set out in the Licensing Act 2003 as amended by the Licensing Act 2003 (Mandatory Licensing Conditions) Order 2010 and Order 2014.

1. No supply of alcohol may be made under the Premises Licence –
 - (a) At a time when there is no Designated Premises Supervisor in respect of the Premises Licence; or
 - (b) At a time when the Designated Premises Supervisor does not hold a Personal Licence or his Personal Licence is suspended
2. Every supply of alcohol under the Premises Licence must be made, or authorised by a person who holds a Personal Licence.
3.
 - (1) The responsible person must ensure that staff on relevant premises do not carry out, arrange or participate in any irresponsible promotions in relation to the premises.
 - (2) In this paragraph, an irresponsible promotion means any one or more of the following activities, or substantially similar activities, carried on for the purpose of encouraging the sale or supply of alcohol for consumption on the premises.
 - a) games or other activities which require or encourage, or are designed to require or encourage, individuals to –
 - (i) drink a quantity of alcohol within a time limit (other than to drink alcohol sold or supplied on the premises before the cessation of the period in which the responsible person is authorised to sell or supply alcohol), or
 - (ii) drink as much alcohol as possible (whether within a time limit or otherwise);
 - b) provision of unlimited or unspecified quantities of alcohol free or for a fixed or discounted fee to the public or to a group defined by a particular characteristic in a manner which carries a significant risk of undermining a licensing objective;
 - c) provision of free or discounted alcohol or any other thing as a prize to encourage or reward the purchase and consumption of alcohol over a period of 24 hours or less in a manner which carries a significant risk of undermining a licensing objective;
 - d) selling or supplying alcohol in association with promotional posters or flyers on, or in the vicinity of, the premises which can reasonably be considered to condone, encourage or glamorise anti-social behaviour or to refer to the effects of drunkenness in any favourable manner.
 - e) dispensing alcohol directly by one person into the mouth of another (other than where that other person is unable to drink without assistance by reason of disability).
4. The responsible person must ensure that free potable water is provided on request to customers where it is reasonably available.

5. (1) The premises licence holder or club premises certificate holder must ensure that an age verification policy is adopted in respect of the premises in relation to the sale or supply of alcohol.
- (2) The designated premises supervisor in relation to the premises licences must ensure that the supply of alcohol at the premises is carried on in accordance with the age verification policy.
- (3) The policy must require individuals who appear to the responsible person to be under 18 years of age (or such older age as may be specified in the policy) to produce on request, before being served alcohol, identification bearing their photograph, date of birth and either:-
- (a) a holographic mark or
 - (b) an ultraviolet feature
6. The responsible person shall ensure that –
- (a) where any of the following alcoholic drinks is sold or supplied for consumption on the premises (other than alcoholic drinks sold or supplied having been made up in advance ready for sale or supply in a securely closed container) it is available to customers in the following measures –
 - (i) beer or cider: ½ pint;
 - (ii) gin, rum, vodka or whisky: 25 ml or 35 ml; and
 - (iii) still wine in a glass: 125 ml; and
 - (b) these measures are displayed in a menu, price list or other printed material which is available to customers on the premises; and
 - (c) where a customer does not in relation to a sale of alcohol specify the quantity of alcohol to be sold, the customer is made aware that these measures are available.

Minimum Drinks Pricing

1. A relevant person shall ensure that no alcohol is sold or supplied for consumption on or off the premises for a price which is less than the permitted price

2. For the purposes of the condition set out in paragraph 1 –

(a) "duty" is to be construed in accordance with the Alcoholic Liquor Duties Act 1979

(b) "permitted price" is the price found by applying the formula –
$$P = D + (D \times V)$$

Where –

(i) P is the permitted price

(ii) D is the amount of duty chargeable in relation to the alcohol as if the duty were charged on the date of the sale or supply of the alcohol, and

(iii) V is the rate of value added tax chargeable in relation to the alcohol as if the value added tax were charged on the date of the sale or supply of the alcohol;

- (c) "relevant person" means, in relation to premises in respect of which there is in force a premises licence –
- (i) The holder of the premises licence
 - (ii) The designated premises supervisor (if any) in respect of such a licence, or
 - (iii) The personal licence holder who makes or authorises a supply of alcohol under such a licence;
- (d) "relevant person" means, in relation to premises in respect of which there is in force a club premises certificate, any member or officer of the club present on the premises in a capacity which enables the member or officer to prevent the supply in question; and
- (e) "value added tax" means value added tax charged in accordance with the Value Added Tax Act 1994.
3. Where the permitted price given by Paragraph (b) of paragraph 2 would (apart from the paragraph) not be a whole number of pennies, the price given by that sub-paragraph shall be taken to be the price actually given by that sub-paragraph rounded up to the nearest penny.
4. (1) Sub-paragraph (2) applies where the permitted price given by Paragraph (b) of paragraph 2 on a day ("the first day") would be different from the permitted price on the next day ("the second day") as a result of a change to the rate of duty or value added tax.
- (2) The permitted price which would apply on the first day applies to sales or supplies of alcohol which take place before the expiry of the period of 14 days beginning on the second day.

If the Premises Licence allows Exhibition of Films

1. Where a premises licence authorises the exhibition of films, the licence must include a condition requiring the admission of children to the exhibition of any film to be restricted in accordance with this section.
 2. Where the film classification body is specified in the licence, unless subsection (3)(b) applies, admission of children must be restricted in accordance with any recommendation by that body.
 3. Where
 - (a) The film classification body is not specified in the licence, or
 - (b) The relevant licensing authority has notified the holder of the licence that this subsection applies to the film in question, admission of children must be restricted in accordance with any recommendation made by that licensing authority.
 4. In this section "children" means any person aged under 18; and
- "film classification body" means the person or persons designated as the authority under Section 4 of the Video Recordings Act 1984(c39) (authority to determine suitability of video works for classification).

**If the Premises Licence has conditions in respect of Door Supervision
except theatres, cinemas, bingo halls and casinos**

1. Where a premises licence includes a condition that at specified times one or more individuals must be at the premises to carry out a security activity, each such individual must:
 - (a) be authorised to carry out that activity by a licence granted under the Private Security Industry Act 2001; or
 - (b) be entitled to carry out that activity by virtue of section 4 of the Act.
2. But nothing in subsection (1) requires such a condition to be imposed:
 - (a) in respect of premises within paragraph 8(3)(a) of Schedule 2 to the Private Security Industry Act 2001 (c12) (premises with premises licences authorising plays or films); or
 - (b) in respect of premises in relation to:
 - (i) any occasion mentioned in paragraph 8(3)(b) or (c) of that Schedule (premises being used exclusively by club with club premises certificate, under a temporary event notice authorising plays or films or under a gaming licence), or
 - (ii) any occasion within paragraph 8(3)(d) of that Schedule (occasions prescribed by regulations under that Act).
3. For the purposes of this section:
 - (a) "security activity" means an activity to which paragraph 2(1)(a) of that Schedule applies, and, which is licensable conduct for the purposes of that Act, (see Section 3(2) of that Act) and
 - (b) paragraph 8(5) of that Schedule (interpretation of references to an occasion) applies as it applies in relation

Annex 2 – Conditions consistent with the Operating Schedule:

The Prevention of Crime and Disorder

- A CCTV system will be maintained which is fit for the purpose. The system will incorporate a camera covering the entrance door and be capable of providing an image which is regarded as identification standard.
- The CCTV system will incorporate a recording facility and any recording will be retained and stored in a suitable and secure manner for a minimum of one calendar month. A system will be in place to maintain the quality of the recorded image and a complete audit trail maintained.
- The CCTV system will be maintained and fully operational throughout the hours that the premises are open for any licensable activity.
- The precise position of the cameras may be agreed with the police from time to time.

Public Safety

- The licence holder will at all times maintain adequate levels of staff. Such staff levels will be disclosed, on request, to the licensing authority and police.

Prevention of Public nuisance

- Adequate waste receptacles for use by customers shall be provided in and immediately outside the premises.

The Protection of children from harm

- All staff will be trained to request evidence of age from any person seeking to buy alcohol and appearing to the member of staff to be under the age of 18. Such evidence is to be of a photographic nature such as a passport or photographic driving licence until other effective identification technology, such as thumbprint or pupil recognition is introduced.
-

Annexe 3 – Conditions attached after a hearing by the licensing authority:

N/A

Annexe 4 – Plans:

Plans held at Epping Forest District Council

**PREMISES LICENCE
SUMMARY**

Part B



**Neighbourhoods
Directorate**

Premises licence number:

LN/210001541

Premises details:

Postal address of premises, or if none, ordnance survey map reference or description:

**BP Express
Chigwell Service Station
The Broadway**

Post Town: Loughton

Post code: IG10 3ST

Telephone number: N/A

Where the licence is time limited the dates: N/A

Licensable activities authorised by the licence:

**Late Night Refreshment
Sale of Alcohol**

The times the licence authorises the carrying out of licensable activities:

**Late Night Refreshment
Monday – Sunday 23.00-05.00**

**Sale of Alcohol
Monday – Sunday 08.00-23.00**

The opening hours of the premises:

Monday – Sunday 00.01 – 00.00

Where the licence authorises supplies of alcohol whether these are on and / or off supplies:

Off Only



Neighbourhoods
Directorate

Name, (registered) address, of holder of premises licence:

BP Oil UK Ltd
Chertsey Road
Sunbury on Thames
Middlesex
TW16 7BP

Registered number of holder, for example company number, charity number (where applicable):

Company 00446915

Name of designated premises supervisor where the premises licence authorises the supply of alcohol:

Thuraiajah Nirupan

State whether access to the premises by children is restricted or prohibited:

N/A

Dated: 14th September 2017

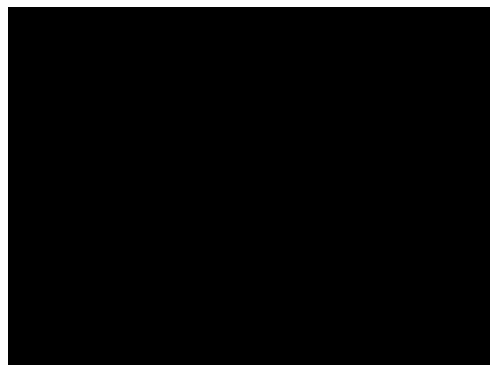

Assistant Director of Neighbourhoods

④	EMERGENCY LIGHTING
④	DORMED CAMERA
④	NEW LED TELLING MONITOR
④	POWDER FIRE EXTINGUISHER
④	CO FIRE EXTINGUISHER
④	FIRE BLANKET
④	SMOKE DETECTOR
④	HEAT DETECTOR
④	EMERGENCY INTERNAL EGRESS SIGNAGE
④	EXTERNAL EMERGENCY EGRESS SIGNAGE

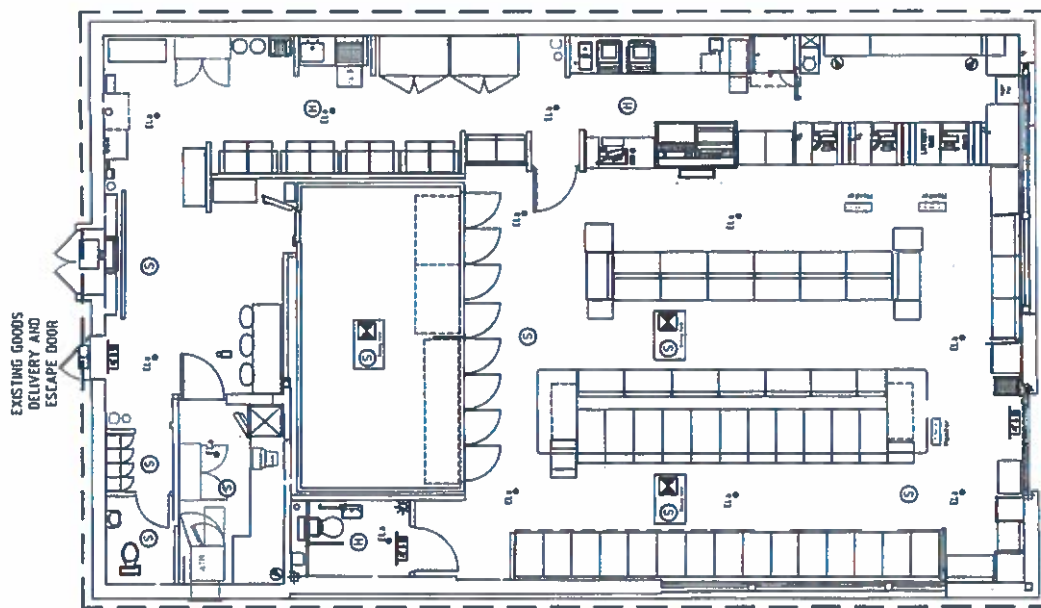

ENTIRE STORE TO BE LICENSED
FOR THE SALE OF ALCOHOL
AND THE PROVISION OF LATE NIGHT
REFRESHMENT

**THE TROLLEYS EACH
CONTAINS OF
2½KG DRY POWDER
AND SAND BURET**

SHOP LAYOUT

1001

A3



SITE OS. LOCATION MAP 1:1250

<p>DATE: 11/11/11 TIME: 11:11 AM BY: [Signature]</p>	<p>PROJECT: [Blank]</p>	<p>DATE: 11/11/11 TIME: 11:11 AM BY: [Signature]</p>	<p>PROJECT: [Blank]</p>	<p>DATE: 11/11/11 TIME: 11:11 AM BY: [Signature]</p>	<p>DATE: 11/11/11 TIME: 11:11 AM BY: [Signature]</p>	<p>PROJECT: [Blank]</p>	<p>DATE: 11/11/11 TIME: 11:11 AM BY: [Signature]</p>	<p>PROJECT: [Blank]</p>	<p>DATE: 11/11/11 TIME: 11:11 AM BY: [Signature]</p>	<p>DATE: 11/11/11 TIME: 11:11 AM BY: [Signature]</p>	<p>PROJECT: [Blank]</p>	<p>DATE: 11/11/11 TIME: 11:11 AM BY: [Signature]</p>	<p>PROJECT: [Blank]</p>	<p>DATE: 11/11/11 TIME: 11:11 AM BY: [Signature]</p>	<p>DATE: 11/11/11 TIME: 11:11 AM BY: [Signature]</p>	<p>PROJECT: [Blank]</p>	<p>DATE: 11/11/11 TIME: 11:11 AM BY: [Signature]</p>	<p>PROJECT: [Blank]</p>	<p>DATE: 11/11/11 TIME: 11:11 AM BY: [Signature]</p>	<p>DATE: 11/11/11 TIME: 11:11 AM BY: [Signature]</p>	<p>PROJECT: [Blank]</p>	<p>DATE: 11/11/11 TIME: 11:11 AM BY: [Signature]</p>	<p>PROJECT: [Blank]</p>	<p>DATE: 11/11/11 TIME: 11:11 AM BY: [Signature]</p>
--	-------------------------	--	-------------------------	--	--	-------------------------	--	-------------------------	--	--	-------------------------	--	-------------------------	--	--	-------------------------	--	-------------------------	--	--	-------------------------	--	-------------------------	--

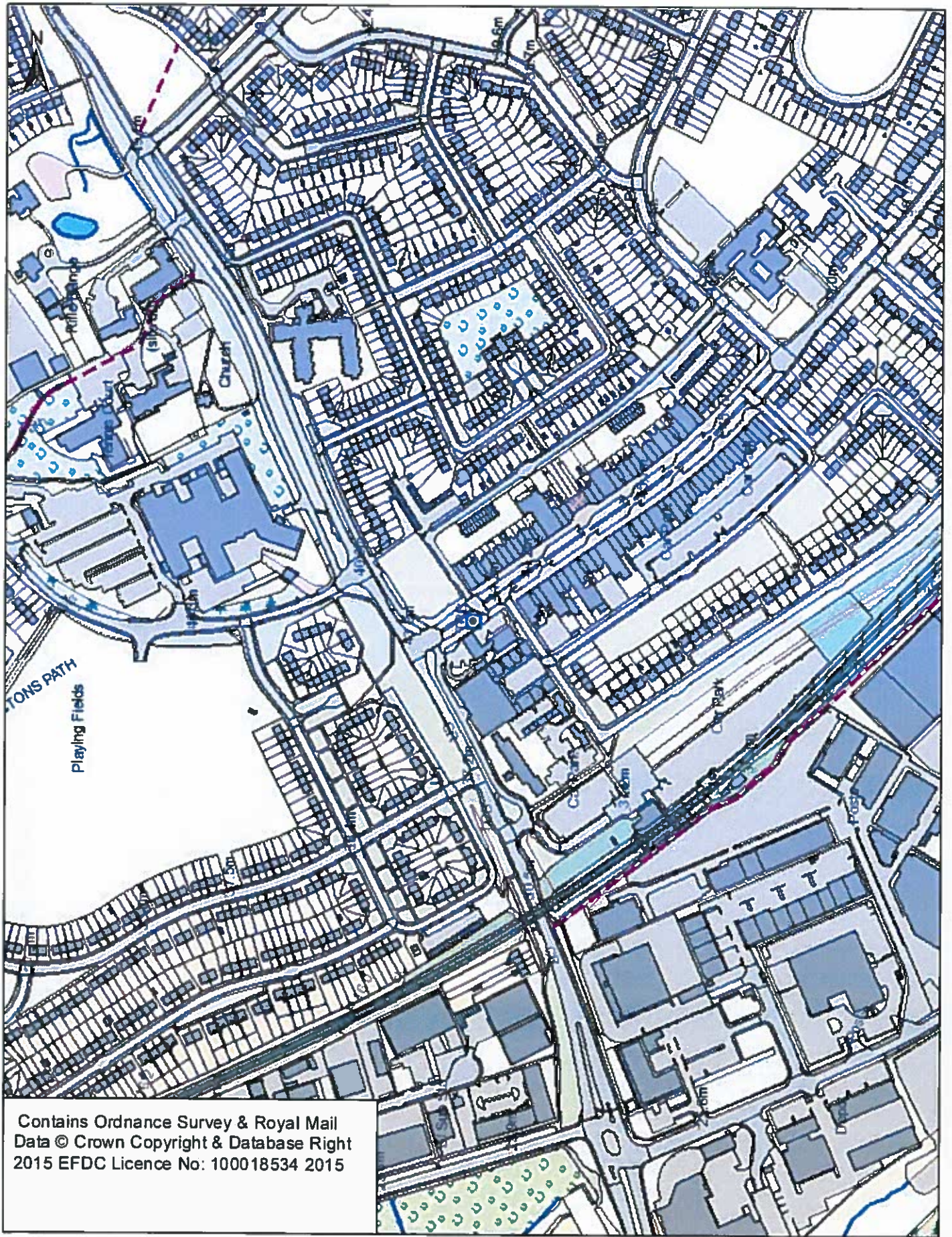

Contains Ordnance Survey & Royal Mail
Data © Crown Copyright & Database Right
2015 EFDC Licence No: 100018534 2015



**Epping Forest
District Council**

BP Chigwell SF Connect

Date: 18/07/2018

Scale: 1:4,000

Name: arcgis

Licensing Act 2003

Application to Vary Premises Licence

Name of Applicant: BP Oil UK Limited

Address: Chigwell SF Connect, The Broadway,
Loughton, IG10 3ST

Licensing Authority: Epping Forest District Council

Licensing Authority Address: Licensing Unit, Epping Forest District
Council, Civic Offices, High Street,
Epping, Essex, CM16 4BZ.
(where a record of the application may be
inspected during normal office hours).

Licensing Authority Website: www.eppingforestdc.gov.uk

The applicant has applied to the Licensing Authority to vary the premises licence for the above premises as follows:

1. To extend the hours for the sale of alcohol to 24 hours a day 7 days a week.
2. To vary the licence conditions.

Any person or responsible authority (as defined by the Licensing Act 2003) may make representations to the Licensing Authority no later than 12 July 2018.

Any representations made to the Licensing Authority must be in writing.

It is an offence to knowingly or recklessly make a false statement in connection with an application and the maximum fine for which a person is liable on summary conviction for the offence is an unlimited fine.

Winckworth Sherwood LLP,
Miderva House, 5 Montague Close,
London, SE1 9BB,
Ref CVE/88/187/RPB.
Solicitors and authorised agents for the applicant

Dated: 14 June 2018

Announcements - Public Notices

Licensing Act 2003:

Application for the Grant of a Premises Licence

Notice of application for the grant of a Premises Licence under section 17 of the Licensing Act 2003.

Notice is hereby given that Buns Group Ltd. have applied to the London Borough of Waltham Forest for the grant of a Premises Licence at 799 Forest Road, Walthamstow, London E17 4JQ.

The nature of the application is to permit the following:

Records of Music, Sale of alcohol consumed on & off premises, Opening hours: 12:00-00:00 Sun-Thur, 12:00-01:00 Fri-Sat

Late night refreshment: 23:00-00:00, Sun-Thur, 23:00-01:00 Fri-Sat

The Licensing register listing full details of the application is kept by the Licensing Service, Magistrates Building, 1 Farnam Avenue, London E17 4NX. The application may be viewed Monday to Friday between the hours of 9am - 5pm (except Bank Holidays).

Any person wishing to make a representation in respect of the above activities may do so in writing to the Licensing Service, Magistrates Building, 1 Farnam Avenue, London E17 4NX.

Representations must be received no later than 5th July 2018.

It is an offence to knowingly or recklessly make a false statement in connection with this application. A person is liable to an unlimited fine on conviction should such a false statement be made.

Licensing Act 2003

Application to Vary Premises Licence

Name of Applicant: BP Oil UK Limited.
Address: Chigwell SF Connect, The Broadway, Loughton, IG10 3ST.
Licensing Authority: Epping Forest District Council.
Address: Licensing Unit, Epping Forest District Council, Civic Offices, High Street, Epping, Essex, CM16 4BZ. (where a record of the application may be inspected during normal office hours).
Licensing Authority Website: www.eppingforestdc.gov.uk
The applicant has applied to the Licensing Authority to vary the premises licence for the above premises as follows:
1. To extend the hours for the sale of alcohol to 24 hours a day 7 days a week.
2. To vary the licence conditions.

Any person or responsible authority (as defined by the Licensing Act 2003) may make representations to the Licensing Authority no later than 12 July 2018. Any representations made to the Licensing Authority must be in writing.
It is an offence to knowingly or recklessly make a false statement in connection with an application and the maximum fine for which a person is liable on summary conviction for this offence is an unlimited fine.

Dated: 14 June 2018
Wincloworth Sherwood LLP,
Minerva House, 5 Montague Close,
London, SE1 9BB.
Ref: C/VE/18/107/APA. Solicitors and authorised agents for the applicant.

Andrey Patricia Mae GRIGGS (deceased)

Pursuant to the Trustee Act 1925 any persons having a claim against or an interest in the Estate of the aforementioned deceased, late of Wansey Hill, Theydon Road, Epping, Essex CM16 4EE, who died on 14th December 2017, are required to send particulars thereof in writing to the undersigned Executors on or before 31st August 2018, after which date the Estate will be distributed having regard only to claims and interests of which they have had notice.

Mt. A. Smith and Mt. A. Smith,
Executors of Mrs. A.P.M. Griggs,
Wansey Hill, Theydon Road, Epping,
Essex CM16 4EE

WALTER DAVID HARDING (Deceased)

Pursuant to the Trustee Act 1925 any persons having a claim against or an interest in the Estate of the above named, late of 22 Parkers Road, Chigwell, Essex IG7 4BN, who died on 03/04/2018, are required to send written particulars thereof to the undersigned on or before 29/06/2018, after which date the Estate will be distributed having regard only to the claims and interests of which they have had notice.

Edward Oliver & Bellis,
19 Broadway Market, Forepiece Road, Barking, Essex IG6 2JW.
Ref: ALK HAR3413 Harding

RHODA ZENA PERL (Deceased)

Pursuant to the Trustee Act 1925 any persons having a claim against or an interest in the Estate of the aforementioned deceased, late of 18 Ardmore Lane Buckhurst Hill IG9 5RY, who died on 29/01/2016, are required to send particulars thereof in writing to the undersigned on or before 31/08/2018, after which date the Estate will be distributed having regard only to claims and interests of which they have had notice.

MONETA PROBATE LIMITED
Concept House
10-12 Gushetown Street Witham
Essex CM8 1BN 733078

FRANCES MAY WARD (Deceased)

Pursuant to the Trustee Act 1925 any persons having a claim against or an interest in the Estate of the aforementioned deceased, late of 6 Foresters Drive Walthamstow London E17 3PG, who died on 08/12/2018, are required to send particulars thereof in writing to the undersigned Solicitors on or before 24/08/2018, after which date the Estate will be distributed having regard only to claims and interests of which they have had notice.

ADAMS SOLICITORS
129 Mile End Road
London E1 4BG 753778

CHRISTINE GEORGINA HUNT (Deceased)

Pursuant to the Trustee Act 1925 any persons having a claim against or an interest in the Estate of the aforementioned deceased, late of 12 Monmouth Avenue South Woodford London E18 1NU, who died on 08/04/2018, are required to send particulars thereof in writing to the undersigned Solicitors on or before 31/08/2018, after which date the Estate will be distributed

Announcements - Public Notices

Essex County Council

(Mill Lane, High Ongar)

(Temporary Prohibition of Traffic) Order 2018

Notice is hereby given that the Essex County Council has made the above Order under Section 14(1) of the Road Traffic Regulation Act 1984.

Effect of the order: To temporarily close that length of Mill Lane, High Ongar in the District of Epping Forest, from its junction with Millfield for a distance of approximately 300m in a southerly direction. The closure is scheduled to commence on 11th July 2018 for 2 days (works to take place between 09:30 - 15:30), or where stated on a valid permit (BC005CC789W000IBPRNVH01 - BT). The scheduled dates may vary for these works with appropriate signs showing and/or displayed on www.roadworks.org. The closure is required for the safety of the public and workforce while new aerial cable works are undertaken by BT.

An alternative route is available via Mill Lane, The Street, Chelmsford Road, High Ongar Road, Four Wantz Roundabout, High Street, Coopers Hill, Brentwood Road, Stondon Road and vice versa.

The Order came into effect on 14th June 2018 and may continue in force for 18 months or until the works have been completed, whichever is the earlier.

(Upland Road, Epping Upland)

(Temporary Prohibition of Traffic) Order 2018

Notice is hereby given that the Essex County Council has made the above Order under Section 14(1) of the Road Traffic Regulation Act 1984.

Effect of the order: To temporarily close that length of Upland Road, Epping Upland in the District of Epping Forest, from its junction with Shingle Hall Drive for a distance of approximately 1060m in an easterly direction. The closure is scheduled to commence on 4th July 2018 for 10 days, or where stated on a valid permit (BC006MU1WBAUSEIBTNP1CU01 - BT). The scheduled dates may vary for these works with appropriate signs showing and/or displayed on www.roadworks.org. The closure is required for the safety of the public and workforce while telegraph pole replacement works are undertaken by BT.

An alternative route is available via Epping Road, Lindsey Street, Palmers Hill, Thornwood Road, High Road Thornwood and vice versa. The Order came into effect on 14th June 2018 and may continue in force for 18 months or until the works have been completed, whichever is the earlier.

(Wrights Green, Little Hallingbury)

(Temporary Prohibition of Traffic) Order 2018

Notice is hereby given that the Essex County Council has made the above Order under Section 14(1) of the Road Traffic Regulation Act 1984.

Effect of the order: To temporarily close that length of Wrights Green, Little Hallingbury in the District of Uttlesford, from both junctions with Goose Lane to the junction with Wrights Green Lane a distance of approximately 460m in a westerly direction. The closure is scheduled to commence on 27th June 2018 for 2 days, or where stated on a valid permit (MX044282444400 - Affinity Water). The scheduled dates may vary for these works with appropriate signs showing and/or displayed on www.roadworks.org. The closure is required for the safety of the public and workforce while new water connection works are undertaken by Affinity Water.

An alternative route is available via Goose Lane, Wrights Green Lane and vice versa.

The Order came into effect on 14th June 2018 and may continue in force for 18 months or until the works have been completed, whichever is the earlier.

(Epping Road, Roydon)

(Temporary Prohibition of Traffic) Order 2018

Notice is hereby given that the Essex County Council intends, not less than seven days from the date of this notice, to make the above Order under Section 14(1) of the Road Traffic Regulation Act 1984.

Effect of the order: To temporarily close that length of Epping Road, Roydon in the District of Epping Forest, from a point approximately 82m north of the junction of Epping Road with Mill Lane, to a point approximately 82m south of the junction of Epping Road with Mill Lane, for a distance of approximately 164m in a southerly direction. The closure is scheduled to commence on 11th July 2018 for 2 days (works to take place between 09:30 - 15:30), or where stated on a valid permit (BC005CC789W000IBPRNVH01 - BT). The scheduled dates may vary for these works with appropriate signs showing and/or displayed on www.roadworks.org. The closure is required for the safety of the public and workforce while new aerial cable works are undertaken by BT.



Loughton Residents Association Plans Group



[REDACTED]

21 June 2018

[REDACTED]

LICENSING APPLICATION, BP Chigwell SF Connect, Chigwell Lane Service

The service station is close to residential properties in The Broadway (over the shops) and in Torrington Drive, and is also close to a motorway junction.

We object to the proposal to sell alcohol 24/7, on the grounds that sales after 11pm are likely to cause a public nuisance, and may also give rise to crime and disorder, by encouraging individuals to congregate in and near the service station, and also by encouraging drink-driving.

Yours sincerely

[REDACTED]

David Linnell, for LRA Plans Group.

Handan Ibrahim

From: Victoria Smith [REDACTED]
Sent: 29 June 2018 20:49
To: Licensing
Subject: BP Licence Application - Against

To Whom It May Concern

With reference to the above Licensing Application I would like to, firstly, say thank you for writing to our household informing us of the application and secondly, let you know that we are Against the application. Our reasons being for this are:

The area of Debden as a whole is a family area, there are lots of young children. There are also lots of teenagers which we believe would encourage them to try and purchase alcohol at all different times of the day and night and this could promote to groups lingering in the streets and fields around. This then leads to litter and mess in currently, nice Green places to be.

It is also a slightly problematic area already with alcoholism and to continue to sell alcohol for 24 hours would impact hugely on this. It would also not help those already struggling themselves as Alcoholics as it makes it more accessible for them.

All of these points above encourage or add to nuisance, unattractive behaviour and will make it an unpleasant area.

There are already 2 express shops at either end of the Broadway selling Alcohol that are open from 6am - 12am, 6 hours short of 24 hours anyway. Plus Sainsbury's supermarket.

Where the BP Garage is situated, it's a very busy through-road also, used by many locals and used by others that do not know the area but drivers may stop for fuel or refreshments and see Alcohol for sale, it could encourage drink driving! Which then leads to accidents.

We feel The Broadway is a pleasant, family place and with these points in mind we really do not feel the need for the BP to have the licence.

Thank you for taking the time to read our views.

Kind regards,
Mrs Smith-Perry

Denise Bastick

From: David Paget [REDACTED]
Sent: 12 July 2018 22:41
To: Licensing
Subject: Application for a 24 hours per day licence to sell alcohol at the BP petrol station at the end of the Broadway in Debden

Dear Sir/Madam,

We are writing to object to the above application. The Police already have evidence of public nuisance and intermittent crime and disorder in the area in and around The Broadway and they have already had to ban gatherings of young people in the area which attracts groups of loitering youth.

Less than half a mile away an all-night alcohol outlet is already available at the Esso petrol station in Church Hill, but a further such facility in The Broadway, which is already a late night focus point for noisy and sometimes disruptive/delinquent youngsters, will encourage unnecessary and excessive alcohol consumption, potentially increasing under-age drinking, public nuisance and crime and disorder in this predominantly residential area.

Yours faithfully,

Mr and Mrs D Paget